

BILL OF MATERIALS

- Siding Materials:**
- 1 - 6" Wide Lap Siding (3.5"x12"x1/32" thick sheet)
 - 1 - 3.25 Wide Scribed Siding (3.5"x6"x1/32" thick sheet)
- Window and Door Castings:**
- 7 - Grandt Line double hung window #5220
 - 2 - Grandt Line 4 pane station door #5088
 - 1 - Grandt Line Double Door w/Transom #5073 (Modified)
 - 1 - Grandt Line 5 Panel Door w/Frame #5021 (Optional)
 - 8 - Angled roof brackets (Ebay sales)
 - 6 - Roof Brackets (Ebay Sales)
 - 1 - Grandt Line Porch Column Turned Wood #5079
- Framing Materials:**
- 120' - 4"x4" Corner trim (8"x8" if using 1/8" thick siding)
 - 120' - 1"x4" Wainscoting trim
 - 120' - 1"x6" Wainscoting Kick Panel
 - 120' - 2"x6" Wainscoting railing (2"x8" if using 1/8" thick siding)
 - 220' - 2"x6" Shed Rafter & Roof Trim
 - 15' - 3"x8" Shed Roof Ridge Beam
 - 600' - 2"x8" Platform Decking
 - 15' - 6"x6" Shed support post (Optional)
 - 400' - 1/8" x 1/8" Platform Framing & Interior bracing
- Roofing Materials:**
- Campbell Shingle material Main Building
 - Campbell Corrugated Sheathing for Shed Roof
- Paint:**
- Floquil RR25 Box Car Red (Windows, Doors & Trim Accent)
 - Floquil RR87 Depot Buff (Main Walls)

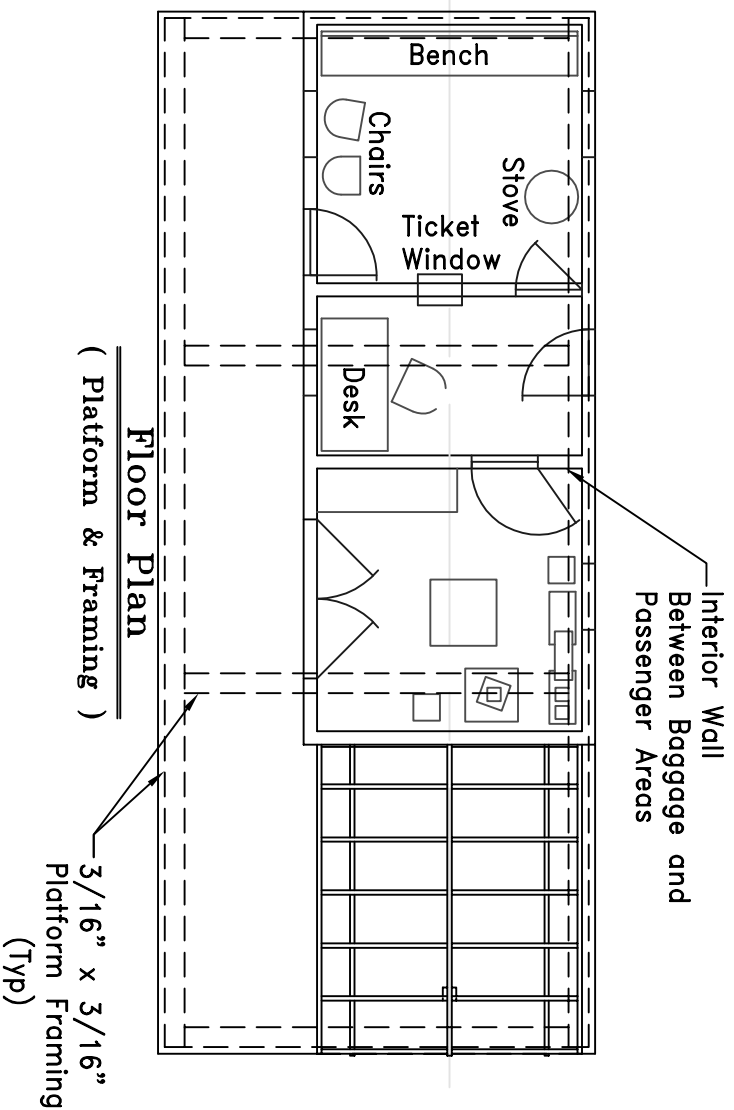

NOTES:

As built 11/23/12

DRAWN BY: CWRailman

SCALE: 1/87 DATE: 08/18/12

Station/Freighthouse
Sheet 2
Floor Plan & Materials

DRAWING NO. B-CW-STRUCT-205 REV. 2